



User manual
BlueprintEasy PDF tagger
English
www.blueprinteasy.no

15-Dec-17
version: 1.0.215.0

Table of content

TABLE OF CONTENT	1
INTRODUCTION	2
INSTALLATION	2
MAKE PRODUCT LIST / PICTURES	2
CHOOSE A DIRECTORY	2
MAKE PICTURES / ICONS / SYMBOLS	3
EXCEL SHEET / PRODUCT LIST	3
WEB LINK TO PRODUCT SHEET ON PDF	3
MULTI PRODUCT LISTS / EXCEL SHEETS	4
START	4
START PROGRAM.....	4
START PROJECT.....	4
IMPORT PDF, JPEG, PNG FILE / DRAWING.....	4
IMPORT PRODUCT LIST(S) / EXCEL FILE(S)	5
DRAG & DROP	5
SELECT A PRODUCT:	5
SELECT MULTIPLE PRODUCTS	5
SELECT – MOVE – DELETE PRODUCT(S).....	5
SEARCH A PRODUCT:	6
POINTER LINES	6
FUNCTIONALITY LIST	7
NAME TEXT ICONS ONTO DRAWING ON/OFF:.....	7
RESET TO SELECTION TOOL ON/OFF.....	7
MULTIPLY ICONS:	7
ZOOM, NAVIGATE, PAN	8
SHORT KEYS:	8
BUTTONS:	8
PROJECT PROPERTIES	8
PROJECT NAME AND REVISIONS.....	8
EXPORT	9
To PDF:.....	9
To EXCEL:.....	9
SAVE PROJECT & COLLABORATE	9
FILE TYPE	9
CLOUD & SHARING.....	10



User manual

BlueprintEasy PDF tagger

English

www.blueprinteasy.no

15-Dec-17

version: 1.0.215.0

and counting of all kinds of products. Typical used with PDF drawings combined with product pictures. Password protected PDF files are supported JPEG and PNG files are also supported.

Installation

www.blueprinteasy.com Enter "My page" or "Log in" enter your username & password and install software to your computer. Support installation for Windows 7, 8 and 10

Make product list / pictures

Choose a directory

Add a folder to save your product pictures. Add excel sheet containing your products

NB: folder and excel sheet to have equal names (see Picture 1)

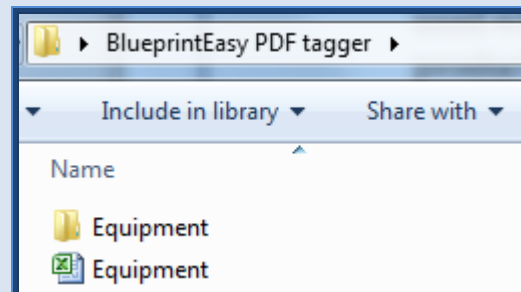

Picture 1

Introduction

BlueprintEasy PDF tagger imports PDF excel and csv files for visual presentation



User manual

BlueprintEasy PDF tagger

English

www.blueprinteasy.no

15-Dec-17

version: 1.0.215.0

Make pictures / icons / symbols

From product sheets, internet, cameras etc. or design them by using other software. Copy or cut from the source and use example Microsoft Paint program to adjust the size of the pictures. PDF vector files are supported for perfect high scale printing.

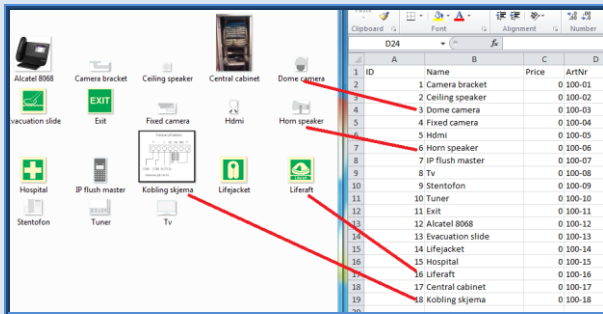

Picture 2

Pictures to be saved in “Equipment” folder. Pictures / icons / symbols size needs to be adjusted according to the exact need and purpose of use.
NB: Pictures / icon file name to be equal (!) to “Name” column in excel sheet (see Picture 2)

Excel sheet / product list

Can be a part of larger excel sheet, but in basic the needed columns are:

“ID”, “Name”, “Price”, “ArtNr”

Columns “ID” and “Name” are obliged to have values. “Price” column need to be 0 or higher, “ArtNr” column is not obliged to fill inn. Still all columns are present at equipment list (see picture 3)

ID	Name	Price	ArtNr	Url
1	Camera bracket	10	100-01.123	www.blueprinteasy.no
2	Ceiling speaker	15	100-02	www.blueprinteasy.no
3	Dome camera	999	100-03	www.blueprinteasy.no
4	Fixed camera	50	100-04	www.blueprinteasy.no
5	Hdmi	3	100-05.124	
6	Horn speaker	15	100-06	
7	IP flush master	100	100-07	
8	Tv	500	100-08	
9	Stentofon	10	100-09	
10	Tuner	11	100-10	
11	Exit	12	100-11	
12	Alcatel 8068	13	100-12	http://www.alcatel8068
13	Evacuation slide	14	100-13	
14	Lifejacket	15	100-14	
15	Hospital	16	100-15	
16	Liferaft	17	100-16	
17	Central cabinet	16	100-17	
18	Kabling skjema	0	100-18	

Picture 3

Web link to product sheet on PDF

Column named «Url» in product list to enter a web link to your product information (see picture 3)

Result on PDF:

Mousepointer over symbol to see web link or eventual name off product – click at symbol to enter the web link.
(see picture 3.1 and 3.2)



User manual

BlueprintEasy PDF tagger

English

www.blueprinteasy.no

15-Dec-17

version: 1.0.215.0



Picture 3.1



Picture 3.2

Multi product lists / excel sheets

Possible to load several excel sheets with different product categories in same project. The excel sheets can also correspond to its own picture folder, for easier maintenance (see picture 4). Only important thing to keep in mind is the "ID" column in each excel sheet. The "ID" needs to be unique! Example of excel lists:
Product 1: ID 0-199

Product 2: ID 200-299

Product 3: ID 300-399

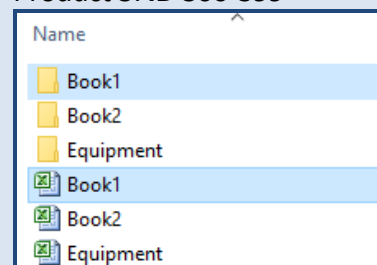

Picture 4

Start

Start program

Double click your desktop icon.



Picture 5

Start project

Press "New" (see picture 6) or select "project" – "New"



Picture 6

Import PDF, JPEG, PNG file / drawing

"Edit" – "Load Main drawing" Choose PDF file to open. Drawing will appear in the left



User manual

BlueprintEasy PDF tagger

English

www.blueprinteasy.no

15-Dec-17

version: 1.0.215.0

window in PDF tagger. (PDF, JPEG, PNG are supported)

[Import product list\(s\) / Excel file\(s\)](#)

“Edit” – “Load Product data” Choose excel file to open.

Product list will appear in the right window

NB: To load several product lists, just repeat same procedure. The product list will now be longer in product window.

(see picture 7)

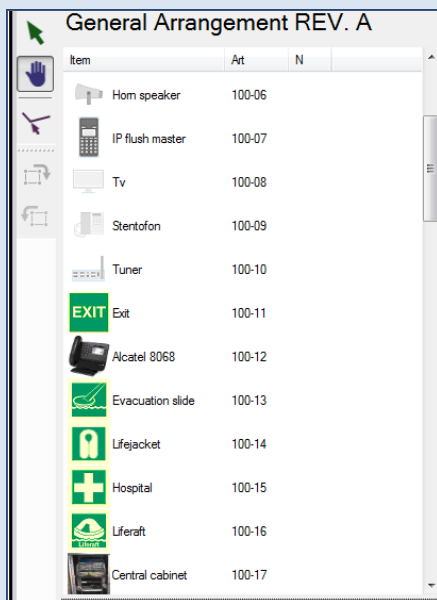

Picture 7

Drag & drop

Select a product:

One click at product list= one product (see picture 7)

Select multiple products

Ctrl or Shift button + mouse click to select several products. (see picture 7)

Select – move – delete product(s)

Select one or several products: Click and hold mouse button – make a frame/square to select area of products to be “active”

“Ctrl” + click can also be used for selecting several products.

Additional features for frame marquee:

(see picture 7.1)

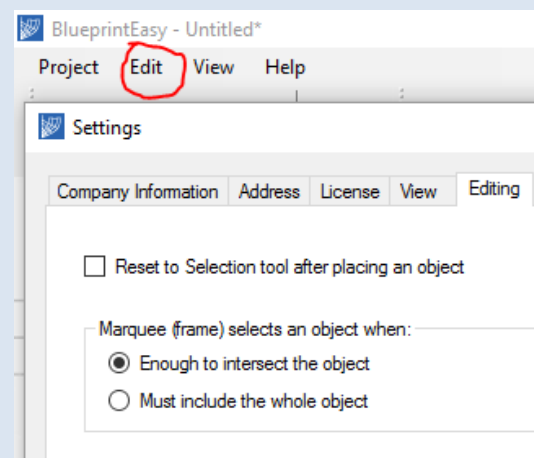

Picture 7.1



Move products: Use mouse or arrow keys for adjusting location.
NB: Shift + arrows = faster
(see picture 8 and 9)

Delete products: Use “Delete” button on keyboard to delete selected product(s).

Or use “edit” – “Delete”

Search a product:

Enter one or two of the first letters in product name. Highlighted chosen product will move. Example: “Ex”
(see picture 8)

Pointer lines

Click + hold + drag + drop (see picture 9)

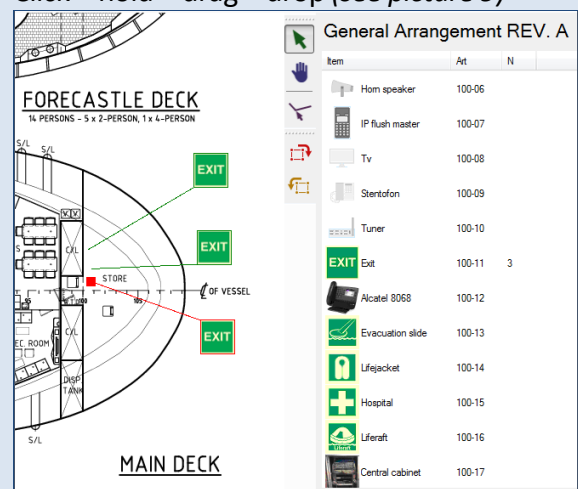

Picture 9

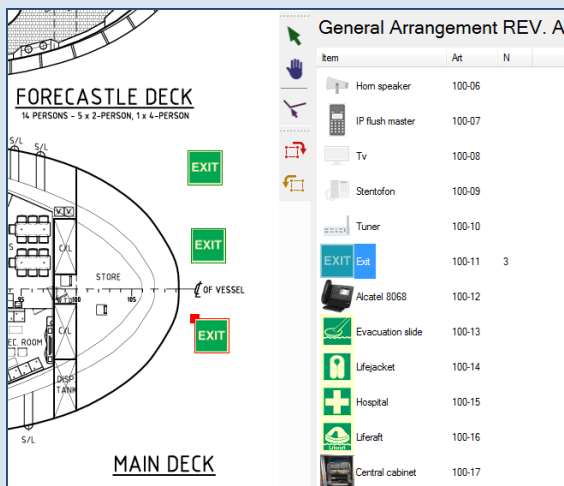









Picture 8

Pointer lines can be set ON/OFF (see functionality list)

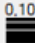
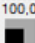

Functionality list

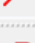
	Selection tool / Release product.
	Pan
	Lines: Mouse click + click + "any button" at keyboard for release. Delete: click at the end or angle of the line - highlight + DELETE key keyboard. Color/thickness: Double click the end or angle of line when highlighted.
	Write text - incl. "marker lines"
	Color for line drawing, text and marker lines
	Thickness line drawing
	Scale symbol size - choose one or several symbols at the drawing first.
	ON/OFF object pointer lines for symbols and text
	Rotate selected item clockwise
	Rotate selected item counterclockwise

Picture 10

Name text icons onto drawing ON/OFF:

"Edit" – "Settings":
Check or uncheck box
(see picture 11)

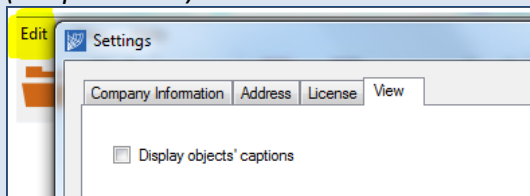

Picture 11

Reset to Selection tool ON/OFF

"Edit" – "Settings":
Check or uncheck box
(see picture 11.1)

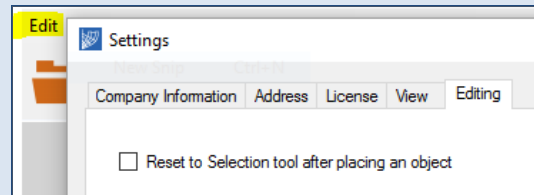

Picture 11.1

Multi page PDF files: Use arrows or drop down menu to change pages
(see picture 12)

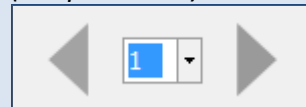

Picture 12

Multiply icons:

Drag & drop a symbol onto drawing – then select arrow (see picture 13)

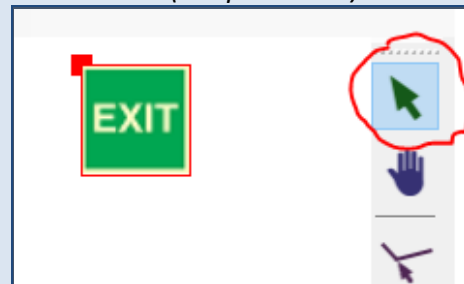

Picture 13



User manual

BlueprintEasy PDF tagger

English

www.blueprinteasy.no

15-Dec-17

version: 1.0.215.0

Double click at symbol – a multiplier box will appear – type amount – OK
(picture 14)

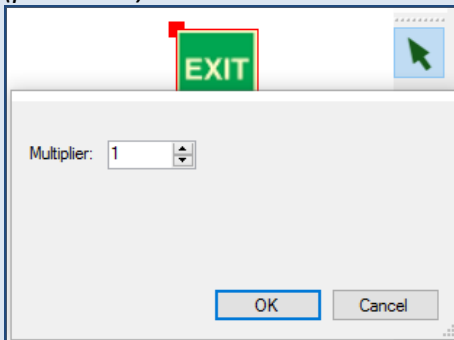

Picture 14

Result: (picture 15)

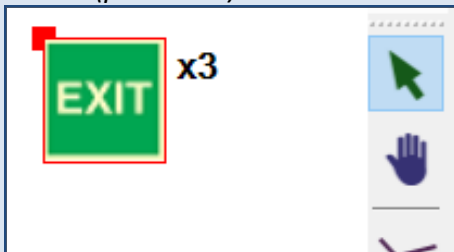

Picture 15

Zoom, Navigate, Pan

Short keys:

Zoom in / out: Ctrl + scroll

Right – left: Shift + scroll

Pan: Spacebar

Buttons:

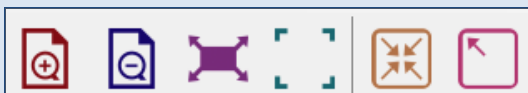

View menu have similar options listed.

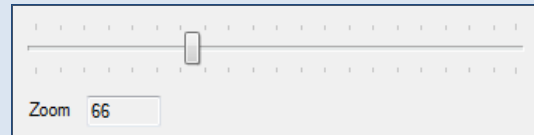

Project properties

Project name and revisions

Menu: “Edit” – “Project properties”:

Name is auto generated from imported PDF file name. Name can be changed.

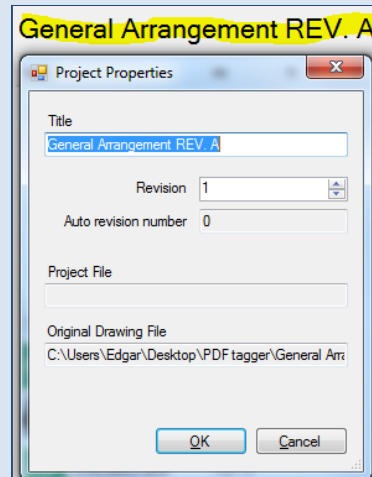

Picture 16

Auto revision number will increase for each save. Revision to be set manually.
(see picture 16)



User manual

BlueprintEasy PDF tagger

English

www.blueprinteasy.no

15-Dec-17

version: 1.0.215.0

Export

To PDF:



Picture 17

When finish placing products, export the file by choose button (see picture 17) and save file.

The exported PDF file contains products, lines and text included additional equipment list.

To Excel:

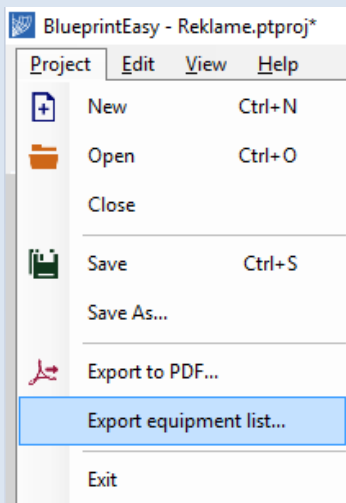

Picture 17.1

Exports productlist to excel with correct amount of symbols placed on drawing (see picture 17.1)

Save project & collaborate



Picture 18

Save project by choose button (see picture 18) or use menu "Project" – "Save" or "Save as". Choose location for your files.

File type

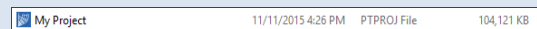

Picture 19

The project file type: PTPROJ file (see picture 19) contains your complete project. Main drawing, product list, symbols, free text, revisions etc. Double click and it will open BlueprintEasy PDF tagger, ready for further editing.



User manual
BlueprintEasy PDF tagger
English
www.blueprinteasy.no

15-Dec-17
version: 1.0.215.0

Cloud & sharing

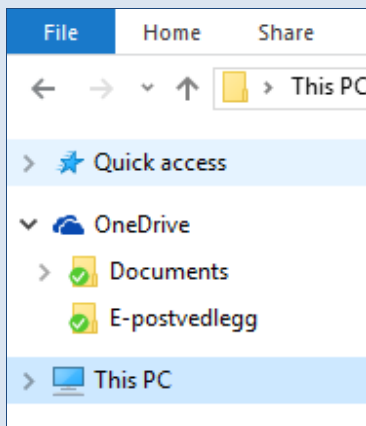

Picture 20

One Drive, Google Drive, Drop box or other cloud save & share solutions can be used for easy maintain and share product lists and project files. Obligated to have the shared folders listed in your file explorer. (see *picture 20*). Then the program can open/save files from shared folders